

Custom high-frequency transformer

TYPE: TEE10/10

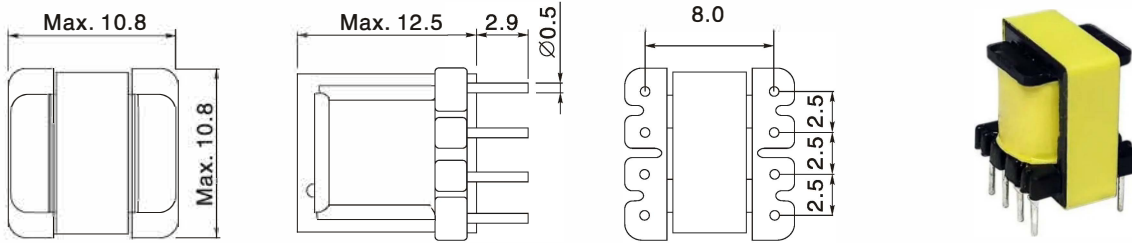

ELECTRICAL CHARACTERISTICS(at 25°C):

Transformer Characteristics Parameters			Magnetic Core Structure Parameters		
Material	Frequency Range	Reference Power	Items	Size	Unit
P3	50kHz	1.2W	C1	2.23	mm ⁻¹
P3	100kHz	2.5W	Ae	11.8	mm ²
P3	300kHz	6.0W	Le	26.3	mm
P3	500kHz	8.9W	Ve	311	mm ³

TYPE: TEE13/12

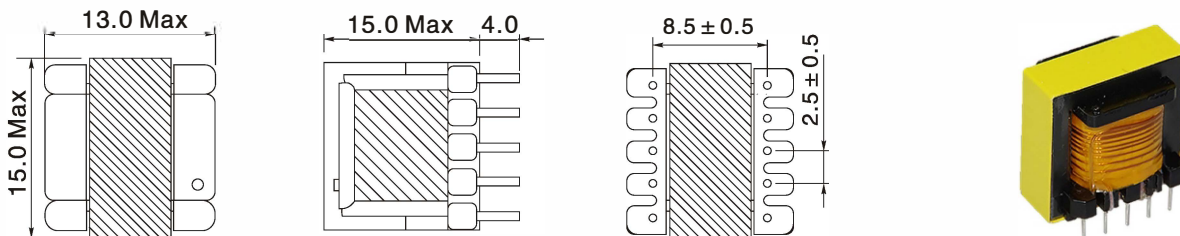

ELECTRICAL CHARACTERISTICS(at 25°C):

Transformer Characteristics Parameters			Magnetic Core Structure Parameters		
Material	Frequency Range	Reference Power	Items	Size	Unit
P3	50kHz	1.4W	C1	1.31	mm ⁻¹
P3	100kHz	3.1W	Ae	23.5	mm ²
P3	300kHz	9.2W	Le	30.7	mm
P3	500kHz	13.4W	Ve	732	mm ³

Custom high-frequency transformer

TYPE: TEE13/12H

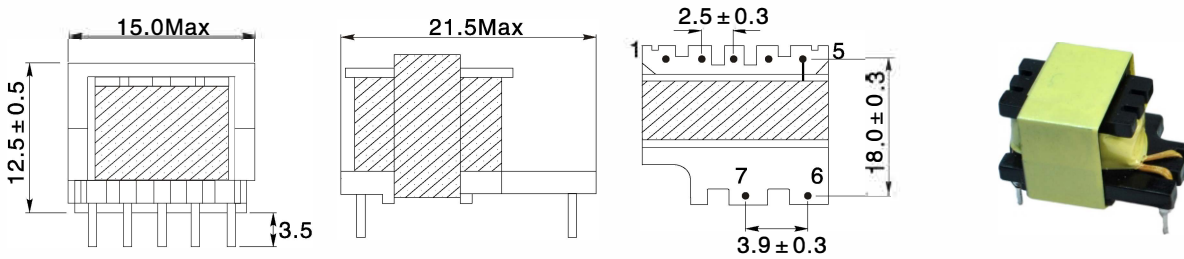

ELECTRICAL CHARACTERISTICS(at 25°C):

Transformer Characteristics Parameters			Magnetic Core Structure Parameters		
Material	Frequency Range	Reference Power	Items	Size	Unit
P3	50kHz	1.4W	C1	1.31	mm ⁻¹
P3	100kHz	3.1W	Ae	23.5	mm ²
P3	300kHz	9.2W	Le	30.7	mm
P3	500kHz	13.4W	Ve	732	mm ³

TYPE: TEE16/14

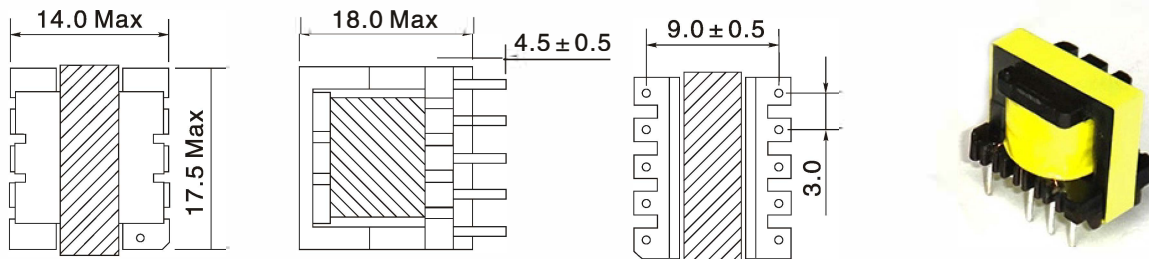

ELECTRICAL CHARACTERISTICS(at 25°C):

Transformer Characteristics Parameters			Magnetic Core Structure Parameters		
Material	Frequency Range	Reference Power	Items	Size	Unit
P3	50kHz	1.8W	C1	1.68	mm ⁻¹
P3	100kHz	3.5W	Ae	21.9	mm ²
P3	300kHz	10.0W	Le	36.7	mm
P3	500kHz	15.0W	Ve	805	mm ³

Custom high-frequency transformer

TYPE: TEE 16/14H

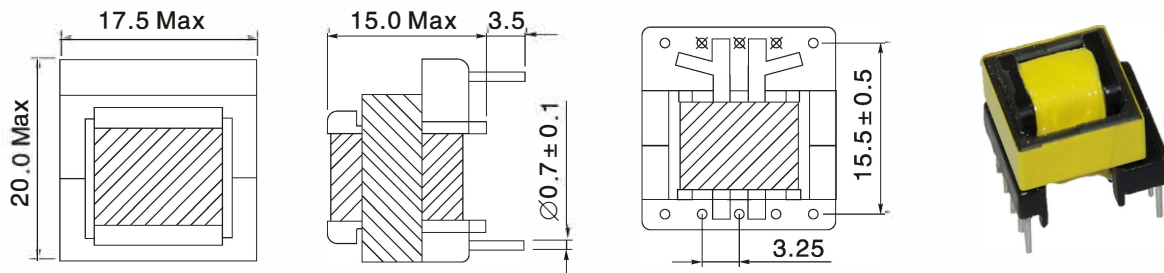

ELECTRICAL CHARACTERISTICS(at 25°C):

Transformer Characteristics Parameters			Magnetic Core Structure Parameters		
Material	Frequency Range	Reference Power	Items	Size	Unit
P3	50kHz	1.8W	C1	1.68	mm ⁻¹
P3	100kHz	3.5W	Ae	21.9	mm ²
P3	300kHz	10.0W	Le	36.7	mm
P3	500kHz	15.0W	Ve	805	mm ³

TYPE: TEE 19/16

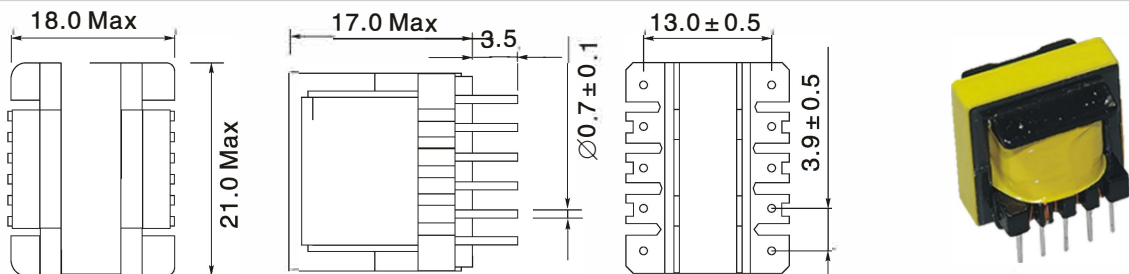

ELECTRICAL CHARACTERISTICS(at 25°C):

Transformer Characteristics Parameters			Magnetic Core Structure Parameters		
Material	Frequency Range	Reference Power	Items	Size	Unit
P3	50kHz	4.0W	C1	1.68	mm ⁻¹
P3	100kHz	8.7W	Ae	23.3	mm ²
P3	300kHz	20.0W	Le	39.2	mm
P3	500kHz	28.0W	Ve	914	mm ³

Custom high-frequency transformer

TYPE: TEE 19/16H

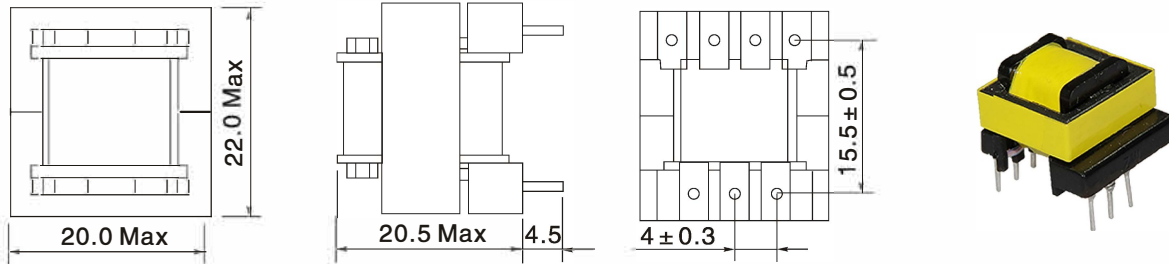

ELECTRICAL CHARACTERISTICS(at 25°C):

Transformer Characteristics Parameters			Magnetic Core Structure Parameters		
Material	Frequency Range	Reference Power	Items	Size	Unit
P3	50kHz	4.0W	C1	1.68	mm ⁻¹
P3	100kHz	8.7W	Ae	23.3	mm ²
P3	300kHz	20.0W	Le	39.2	mm
P3	500kHz	28.0W	Ve	914	mm ³

TYPE: TEE 19/27

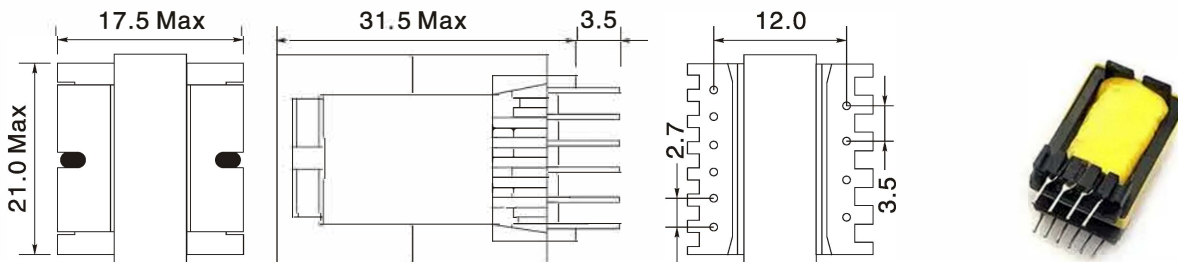

ELECTRICAL CHARACTERISTICS(at 25°C):

Transformer Characteristics Parameters			Magnetic Core Structure Parameters		
Material	Frequency Range	Reference Power	Items	Size	Unit
P3	50kHz	4.5W	C1	2.67	mm ⁻¹
P3	100kHz	9.2W	Ae	23.0	mm ²
P3	300kHz	21.5W	Le	62.1	mm
P3	500kHz	30.0W	Ve	1428	mm ³

Custom high-frequency transformer

TYPE: TEE 22/30H

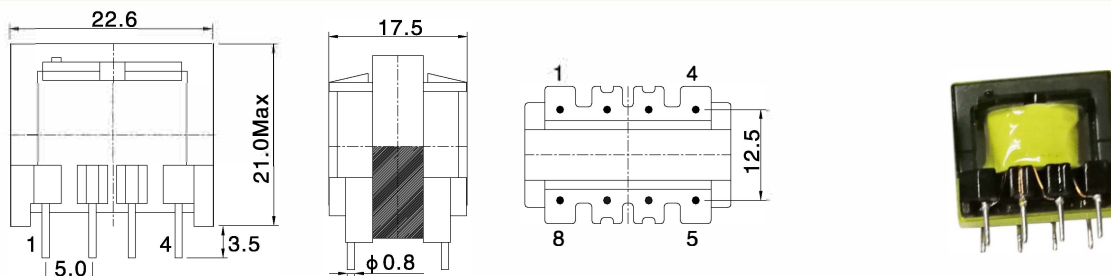

ELECTRICAL CHARACTERISTICS(at 25°C):

Transformer Characteristics Parameters			Magnetic Core Structure Parameters		
Material	Frequency Range	Reference Power	Items	Size	Unit
P3	50kHz	7.0W	C1	1.82	mm ⁻¹
P3	100kHz	15.0W	Ae	34.9	mm ²
P3	300kHz	40.0W	Le	63.5	mm
P3	500kHz	60.0W	Ve	2272	mm ³

TYPE: TEE 22/20

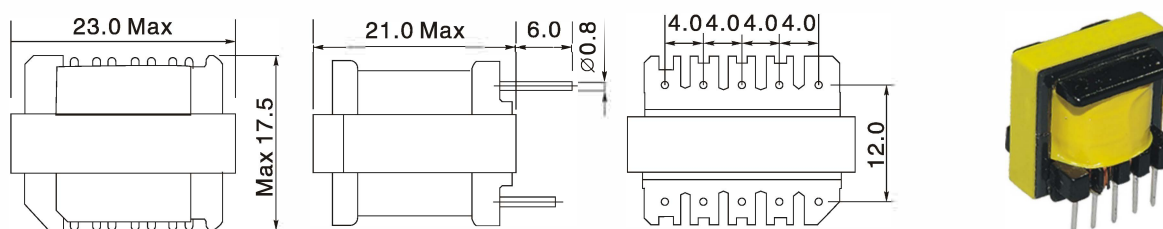

ELECTRICAL CHARACTERISTICS(at 25°C):

Transformer Characteristics Parameters			Magnetic Core Structure Parameters		
Material	Frequency Range	Reference Power	Items	Size	Unit
P3	50kHz	4.0W	C1	2.06	mm ⁻¹
P3	100kHz	8.0W	Ae	24.8	mm ²
P3	300kHz	18.0W	Le	51.1	mm
P3	500kHz	25.0W	Ve	1268	mm ³

Custom high-frequency transformer

TYPE: TEE 25/20

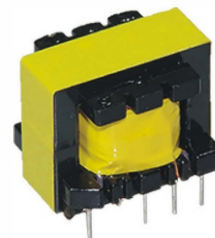

ELECTRICAL CHARACTERISTICS(at 25°C):

Transformer Characteristics Parameters			Magnetic Core Structure Parameters		
Material	Frequency Range	Reference Power	Items	Size	Unit
P3	50kHz	8.5W	C1	1.23	mm ⁻¹
P3	100kHz	16.0W	Ae	40.7	mm ²
P3	300kHz	38.0W	Le	49.9	mm
P3	500kHz	46.0W	Ve	2034	mm ³

TYPE: TEE 28/20

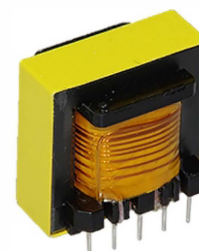
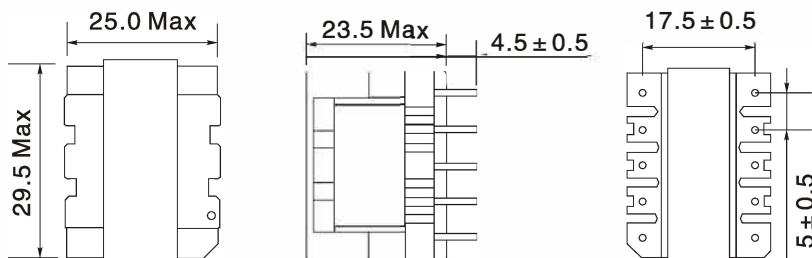

ELECTRICAL CHARACTERISTICS(at 25°C):

Transformer Characteristics Parameters			Magnetic Core Structure Parameters		
Material	Frequency Range	Reference Power	Items	Size	Unit
P3	50kHz	10.5W	C1	1.96	mm ⁻¹
P3	100kHz	22.0W	Ae	81.1	mm ²
P3	300kHz	51.0W	Le	51.9	mm
			Ve	4210	mm ³

Custom high-frequency transformer

TYPE: TEE 30/30

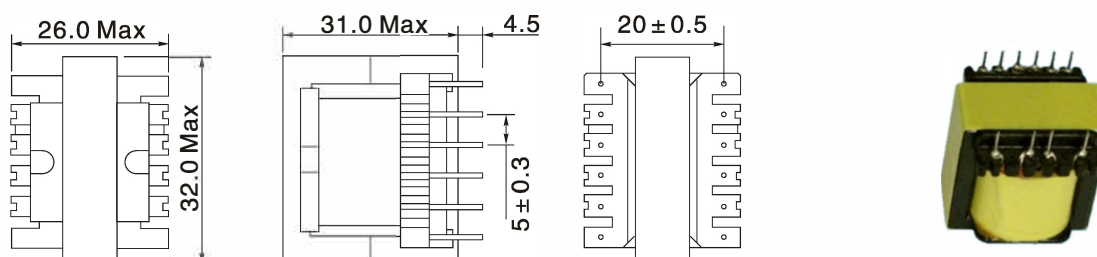

ELECTRICAL CHARACTERISTICS(at 25°C):

Transformer Characteristics Parameters			Magnetic Core Structure Parameters		
Material	Frequency Range	Reference Power	Items	Size	Unit
P3	50kHz	17.0W	C1	1.10	mm ⁻¹
P3	100kHz	29.0W	Ae	59.0	mm ²
P3	300kHz	45.0W	Le	66.1	mm
			Ve	3901	mm ³

TYPE: TEE 35/28

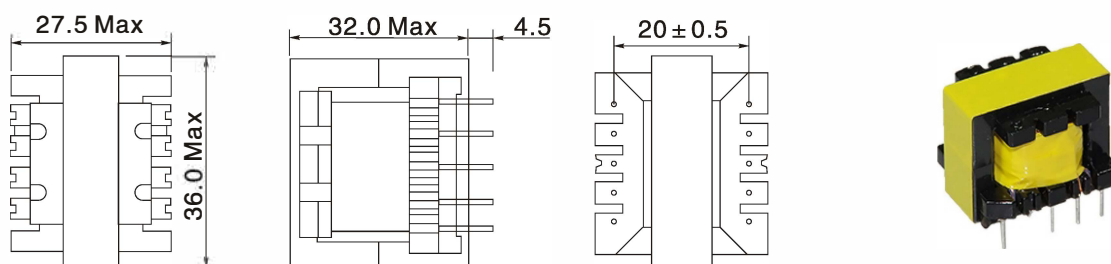

ELECTRICAL CHARACTERISTICS(at 25°C):

Transformer Characteristics Parameters			Magnetic Core Structure Parameters		
Material	Frequency Range	Reference Power	Items	Size	Unit
P3	50kHz	20.0W	C1	0.83	mm ⁻¹
P3	100kHz	38.0W	Ae	84.3	mm ²
P3	300kHz	85.0W	Le	69.7	mm
			Ve	5871	mm ³

Custom high-frequency transformer

TYPE: TEE 40/35

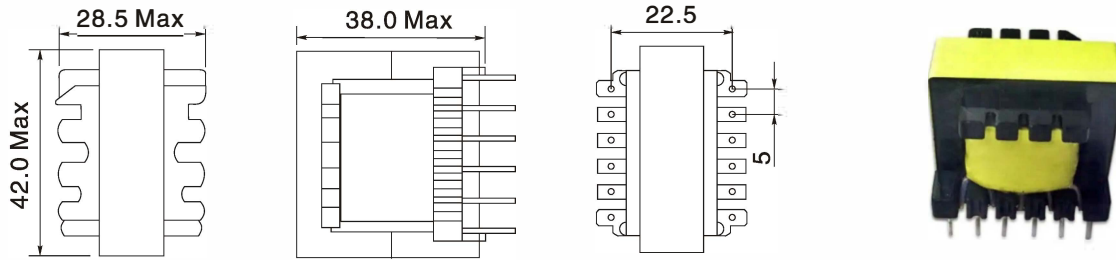

ELECTRICAL CHARACTERISTICS(at 25°C):

Transformer Characteristics Parameters			Magnetic Core Structure Parameters		
Material	Frequency Range	Reference Power	Items	Size	Unit
P3	50kHz	25W	C1	0.52	mm ⁻¹
P3	100kHz	40W	Ae	147.9	mm ²
P3	300kHz	120W	Le	77.2	mm
			Ve	11.42	cm ³

TYPE: TEE 40/35H

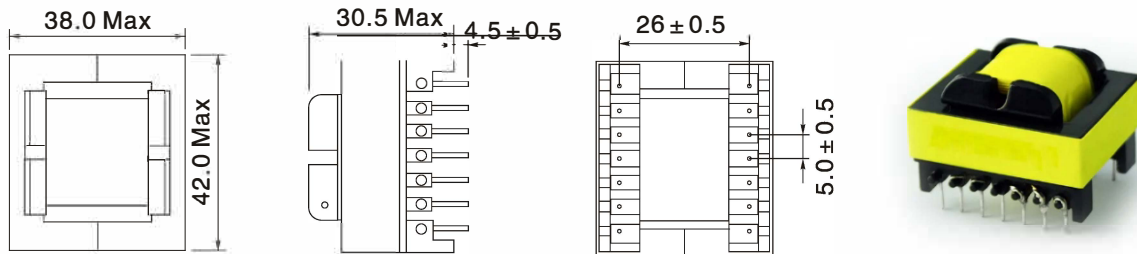

ELECTRICAL CHARACTERISTICS(at 25°C):

Transformer Characteristics Parameters			Magnetic Core Structure Parameters		
Material	Frequency Range	Reference Power	Items	Size	Unit
P3	50kHz	25W	C1	0.52	mm ⁻¹
P3	100kHz	40W	Ae	147.9	mm ²
P3	300kHz	120W	Le	77.2	mm
			Ve	11.42	cm ³