

NO. OF CONTACTS	A	B	C
9	.500	.395	.200
15	.650	.545	.350
21	.800	.695	.500
25	.900	.795	.600
31	1.050	.945	.750
37	1.200	1.095	.900
51	1.550	1.445	1.250

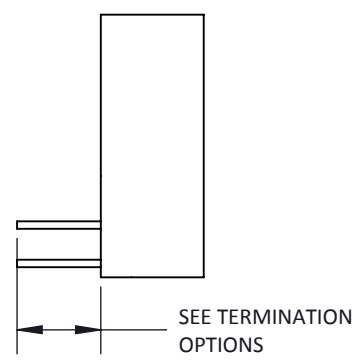
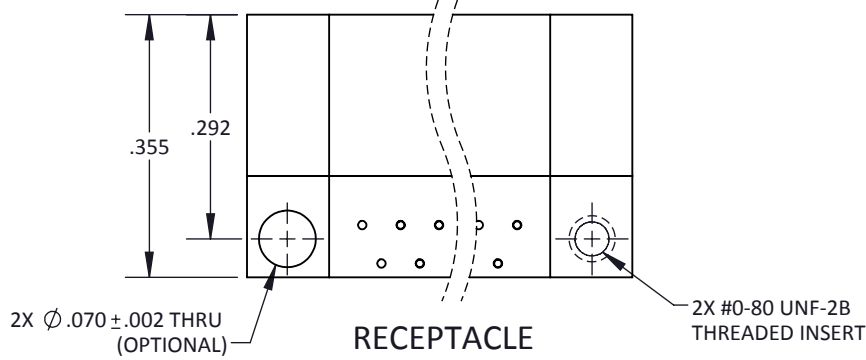

(FOR PLUG AND RECEPTACLE PCB LAYOUTS, SEE SHEETS 3 AND 4)

TOLERANCE: .XXX ±.005
.XX ±.01
ANGLE ±1°

TITLE
NANO METAL SHELL
SINGLE ROW RIGHT ANGLE
BOARD MOUNT

SHT 1 OF 4

DWG. NO.
BRN1

REV
E



NANO METAL SHELL SINGLE ROW RIGHT ANGLE BOARD MOUNT

BRN 1 - XX X - T X X - X

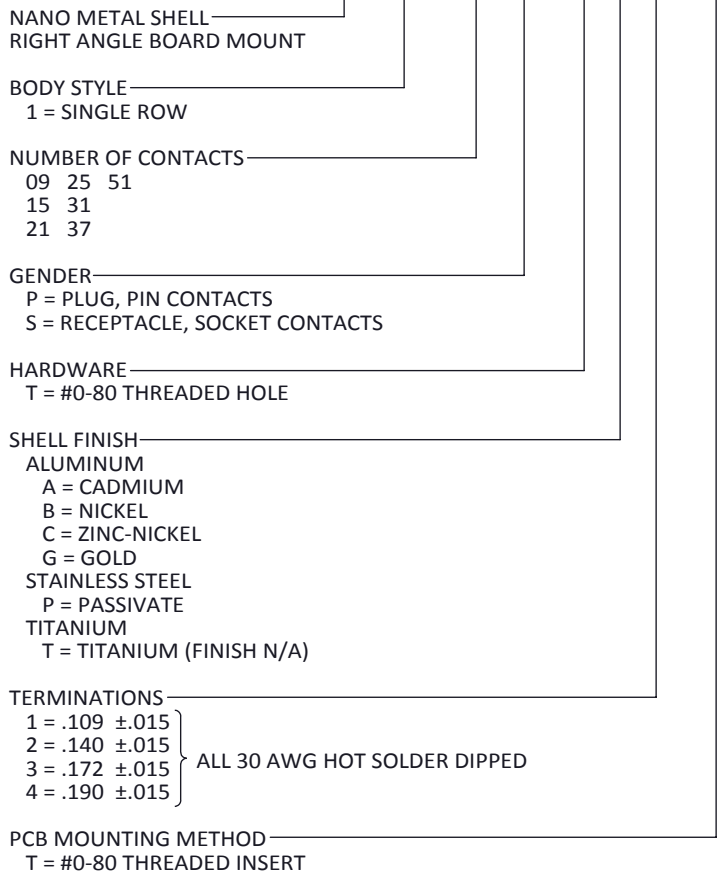

MATERIALS AND FINISHES ARE IAW MIL-DTL-32139
FOR DETAILS SEE MIL SPEC OR WWW.CRISTEK.COM

1. MATERIALS:

SHELL - ALUMINUM ALLOY OR STAINLESS STEEL
OR TITANIUM
INSULATOR - LIQUID CRYSTAL POLYMER OR
GLASS FILLED THERMOPLASTIC
CONTACT - COPPER ALLOY

2. FINISH:

SHELL - CADMIUM OVER ELECTROLESS NICKEL
OR PASSIVATE OR GOLD OR ZINC-NICKEL
CONTACT - GOLD OVER NICKEL

3. SPECIFICATIONS:

CURRENT RATING ----- 1 AMP MAX
TEMPERATURE RATING ----- -55° C TO +125° C
INSULATION RESISTANCE ----- 5000 MEGOHMS
DWV AT SEA LEVEL ----- 250 VAC
DWV AT 70,000 FT ALTITUDE --- 100 VAC
CONTACT RESISTANCE ----- 71 mV DROP MAX @ 1 A
CONTACT RETENTION ----- 2 LBS AXIAL LOAD
ENGAGEMENT FORCE ----- 5 oz MAX
SEPARATION FORCE ----- 0.4 oz MIN

4. ADDITIONAL INFORMATION:

FOR OTHER TERMINATIONS, CONTACT CRISTEK.

TOLERANCE: .XXX ±.005 .XX ±.01 ANGLE ±1°	TITLE NANO METAL SHELL SINGLE ROW RIGHT ANGLE BOARD MOUNT	SHT 2 OF 4	DWG. NO. BRN1	REV E
--	---	--------------------------	-----------------------------	---------------------

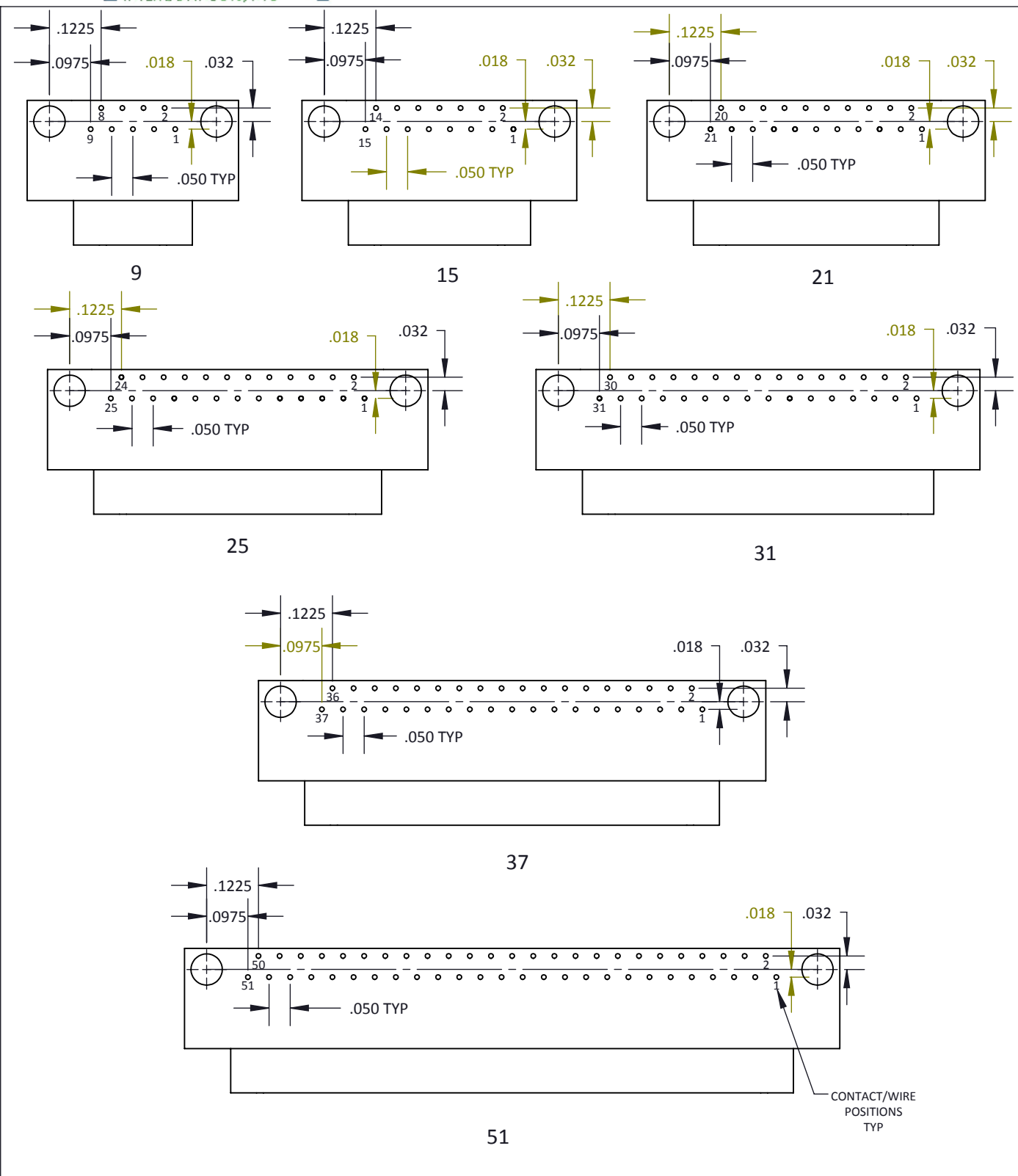

BRN1 PLUG PCB LAYOUTS
.050 X .050 GRID PATTERN OFFSET .025

TOLERANCE: .XXX ±.005 .XX ±.01 ANGLE ±1°
--

TITLE NANO METAL SHELL SINGLE ROW RIGHT ANGLE BOARD MOUNT
--

SHT 3 OF 4

DWG. NO. BRN1

REV E

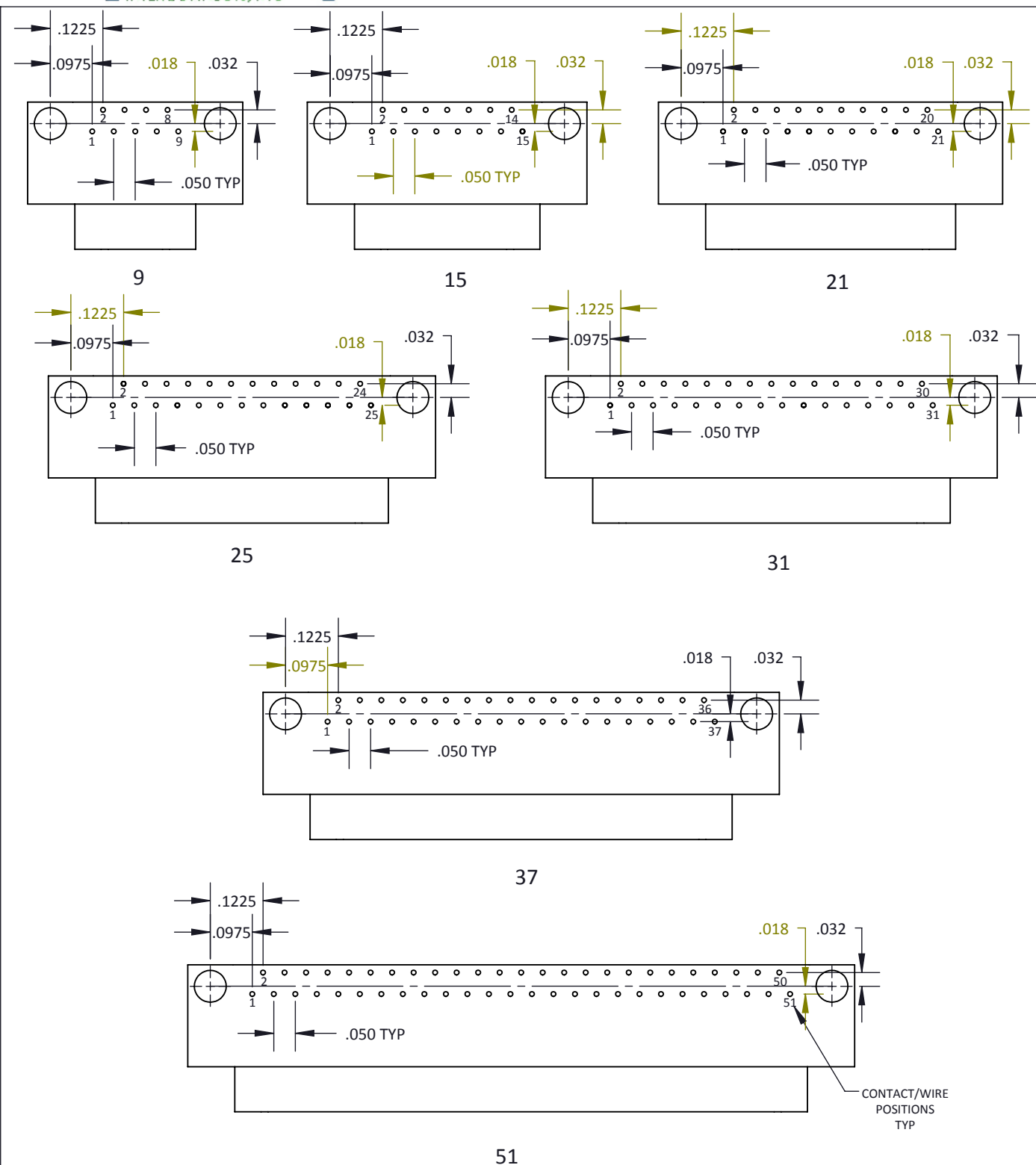

BRN1 RECEPTACLE PCB LAYOUTS
.050 X .050 GRID PATTERN OFFSET .025

<p>TOLERANCE: .XXX ±.005 .XX ±.01 ANGLE ±1°</p>	<p>TITLE NANO METAL SHELL SINGLE ROW RIGHT ANGLE BOARD MOUNT</p>	<p>SHT 4 OF 4</p>	<p>DWG. NO. BRN1</p>	<p>REV E</p>
---	--	-------------------	--------------------------	------------------

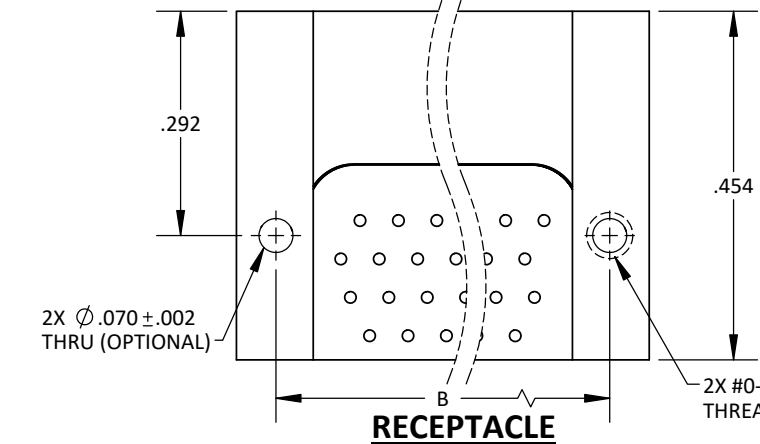
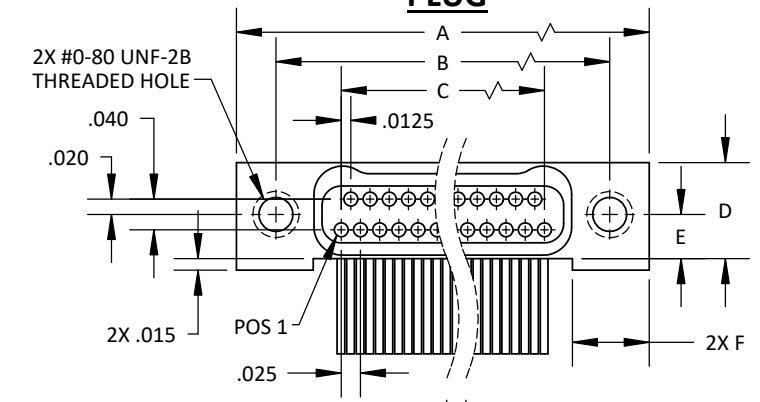
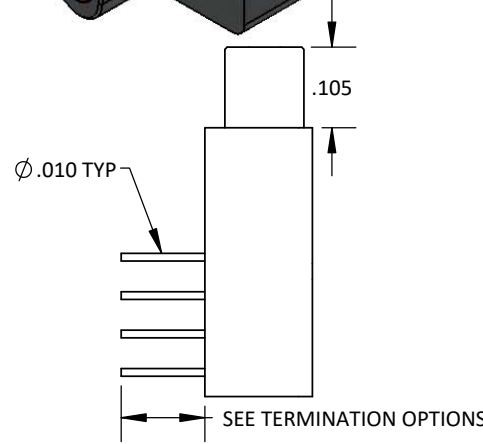
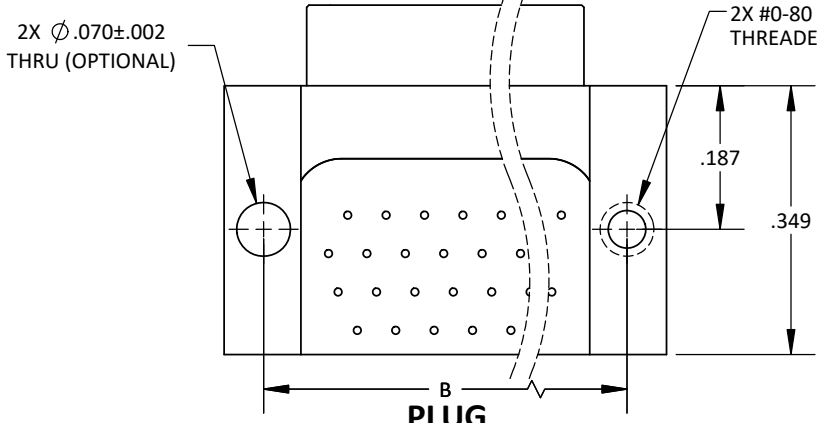
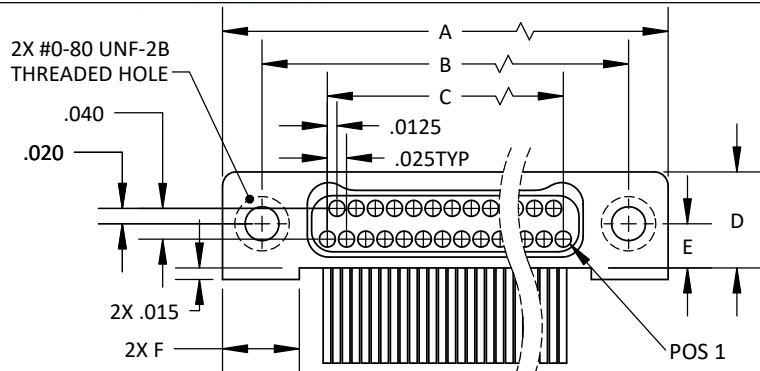
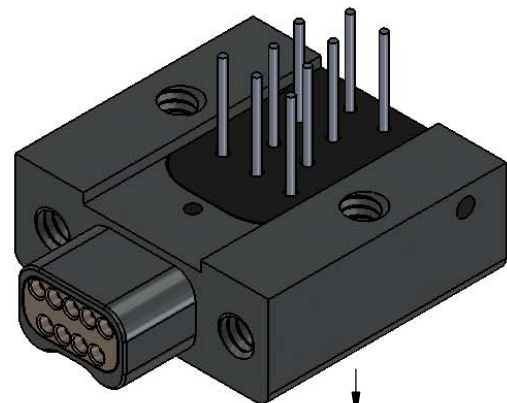

NO. OF CONTACTS	A	B	C	D	E	F
9	.375	.270	.100			
15	.450	.345	.175			
21	.525	.420	.250			
25	.575	.470	.300			
31	.650	.545	.375	.125	.0575	.105
37	.725	.620	.450			
51	.900	.795	.625			
65	1.075	.970	.800			
69	1.125	1.020	.850			
85	1.377	1.246	1.050			
91	1.452	1.321	1.125	.150	.070	.128

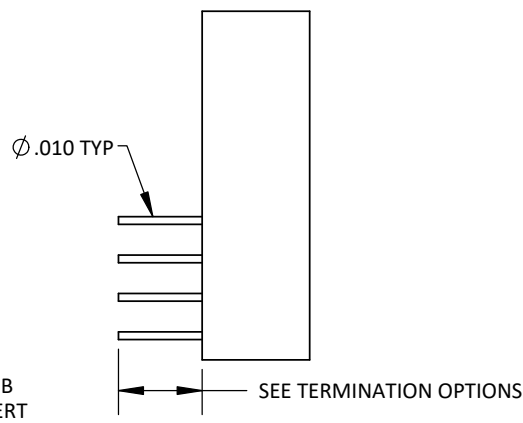

(FOR PLUG AND RECEPTACLE PCB LAYOUTS, SEE SHEETS 3 AND 4)

TOLERANCE: .XXX ±.005 .XX ±.01 ANGLE ±1°	TITLE NANO METAL SHELL DUAL ROW RIGHT ANGLE BOARD MOUNT	SHT 1 OF 4	DWG. NO. BRN2	REV J
--	---	------------	-------------------------	-----------------

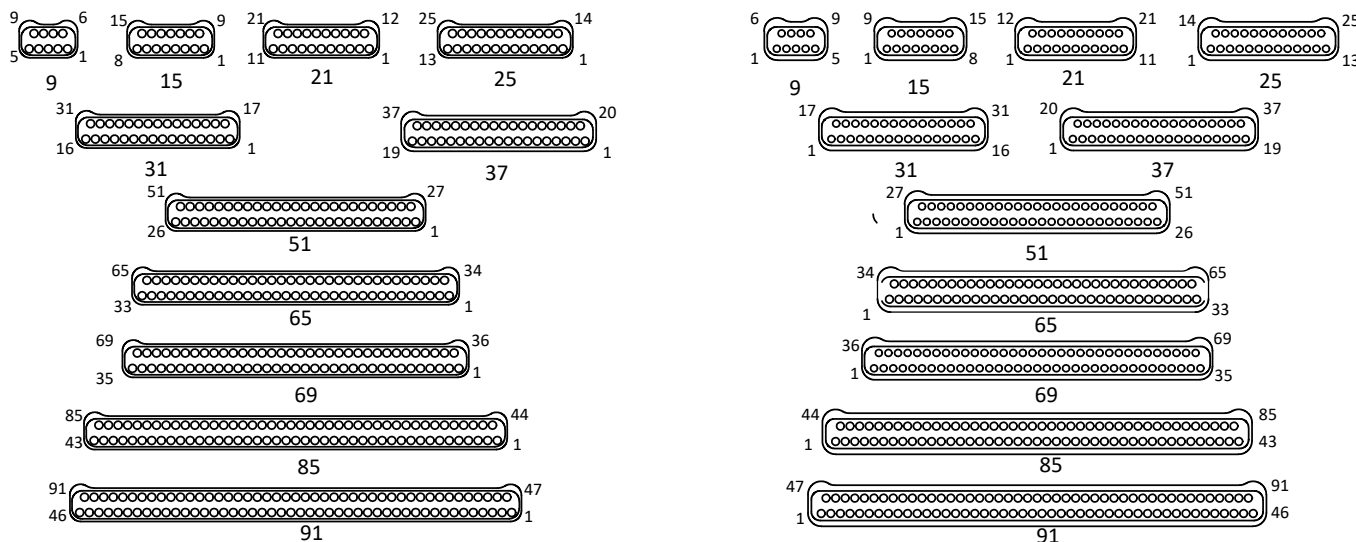

PLUG FACE

RECEPTACLE FACE

BRN 2 - XX X - T X X - X

NANO METAL SHELL
RIGHT ANGLE BOARD MOUNT

BODY STYLE
2 = DUAL ROW

NUMBER OF CONTACTS
09 25 51 85
15 31 65 91
21 37 69

GENDER
P = PLUG, PIN CONTACTS
S = RECEPTACLE, SOCKET CONTACTS

HARDWARE
T = #0-80 (SIZES 9-69) THREADED HOLE
OR #2-56 (SIZES 85 & 91) THREADED INSERT

SHELL FINISH
ALUMINIUM
A = CADMIUM
B = NICKEL
C = ZINC-NICKEL
G = GOLD
STAINLESS STEEL
P = PASSIVATE
TITANIUM
T = TITANIUM (FINISH N/A)

TERMINATIONS
1 = .109 ±.015
2 = .140 ±.015
3 = .172 ±.015
4 = .190 ±.015
ALL 30 AWG HOT SOLDER DIPPED

PCB MOUNTING METHOD
T = #0-80 (SIZES 9-69) THREADED HOLE OR #2-56 (SIZES 85 & 91) THREADED INSERT
(OMIT FOR THROUGH HOLE .070 (SIZES 9-69) OR .092 (SIZES 85 & 91))

MATERIALS AND FINISHES ARE IAW MIL-DTL-32139
FOR DETAILS SEE MIL SPEC OR WWW.CRISTEK.COM

1. MATERIALS:

- SHELL - ALUMINUM ALLOY OR STAINLESS STEEL OR TITANIUM
- INSULATOR - LIQUID CRYSTAL POLYMER OR GLASS FILLED THERMOPLASTIC
- CONTACT - COPPER ALLOY

2. FINISH:

- SHELL - ELECTROLESS NICKEL OR CADMIUM OVER ELECTROLESS NICKEL OR GOLD OR PASSIVATE OR ZINC-NICKEL
- CONTACT - GOLD OVER NICKEL

3. SPECIFICATIONS:

- CURRENT RATING ----- 1 AMP MAX
- TEMPERATURE RATING ----- -55° C TO +125° C
- INSULATION RESISTANCE ----- 5000 MEGOHMS DWV AT SEA LEVEL ----- 250 VAC DWV AT 70,000 FT ALTITUDE --- 100 VAC
- CONTACT RESISTANCE ----- 71 mV DROP MAX @ 1 A
- CONTACT RETENTION ----- 2 LBS AXIAL LOAD
- ENGAGEMENT FORCE ----- 5 oz MAX
- SEPARATION FORCE ----- 0.4 oz MIN

4. ADDITIONAL INFORMATION:

FOR OTHER TERMINATIONS, CONTACT CRISTEK.

5. SIZE 85 & 91 HARDWARE IS #2-56

TOLERANCE: .XXX ±.005 .XX ±.01 ANGLE ±1°	TITLE NANO METAL SHELL DUAL ROW RIGHT ANGLE BOARD MOUNT	SHT 2 OF 4	DWG. NO. BRN2	REV J
--	---	------------	-------------------------	-----------------

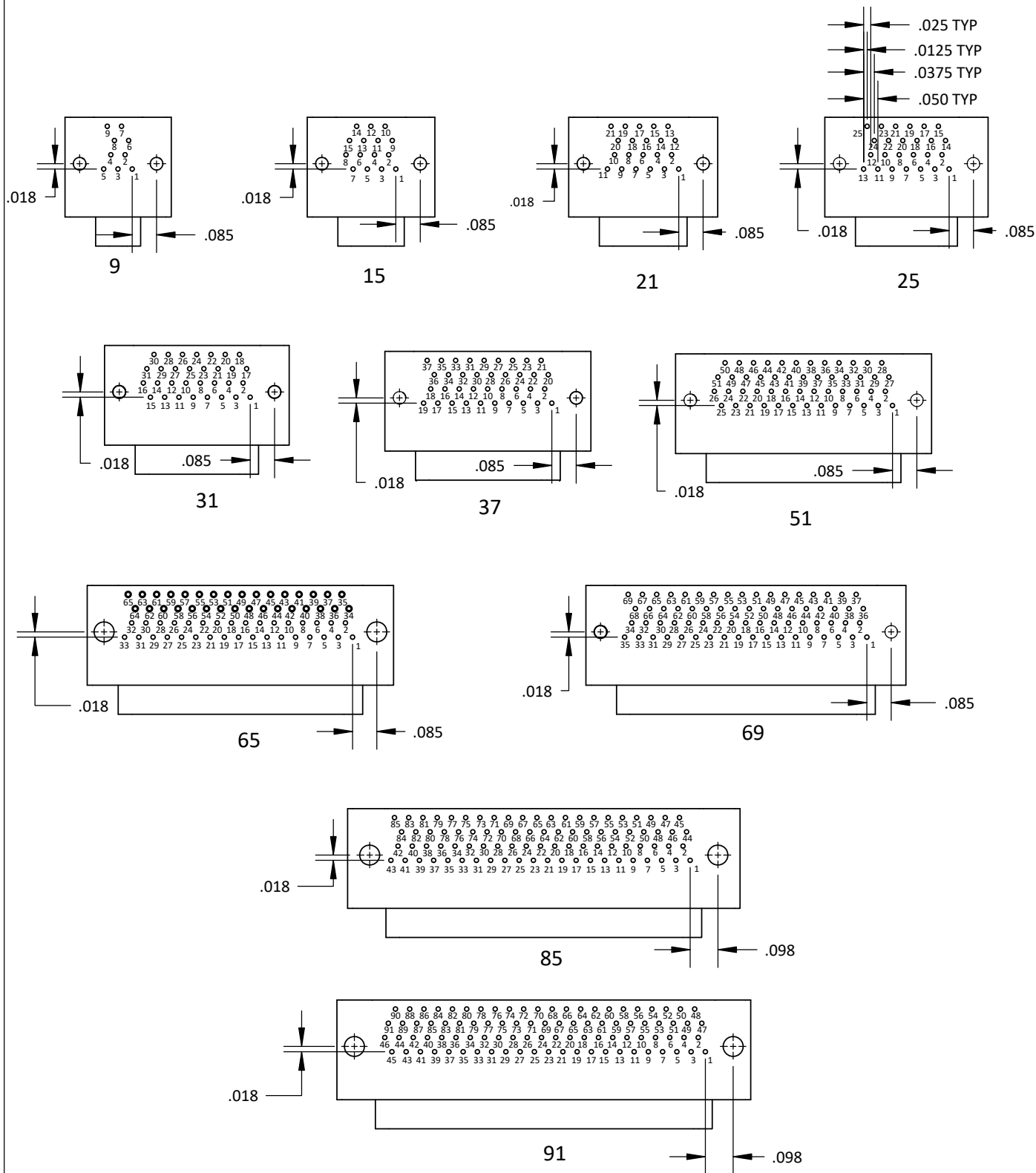

BRN2 PLUG PCB LAYOUTS
.050 X .050 GRID PATTERN OFFSET .025 (EACH ROW)

<p>TOLERANCE: .XXX ±.005 .XX ±.01 ANGLE ±1°</p>	<p>TITLE NANO METAL SHELL DUAL ROW RIGHT ANGLE BOARD MOUNT</p>	<p>SHT 3 OF 4</p>	<p>DWG. NO. BRN2</p>	<p>REV J</p>
---	--	-------------------	--------------------------	------------------

**NANO METAL SHELL DUAL ROW
RIGHT ANGLE BOARD MOUNT**

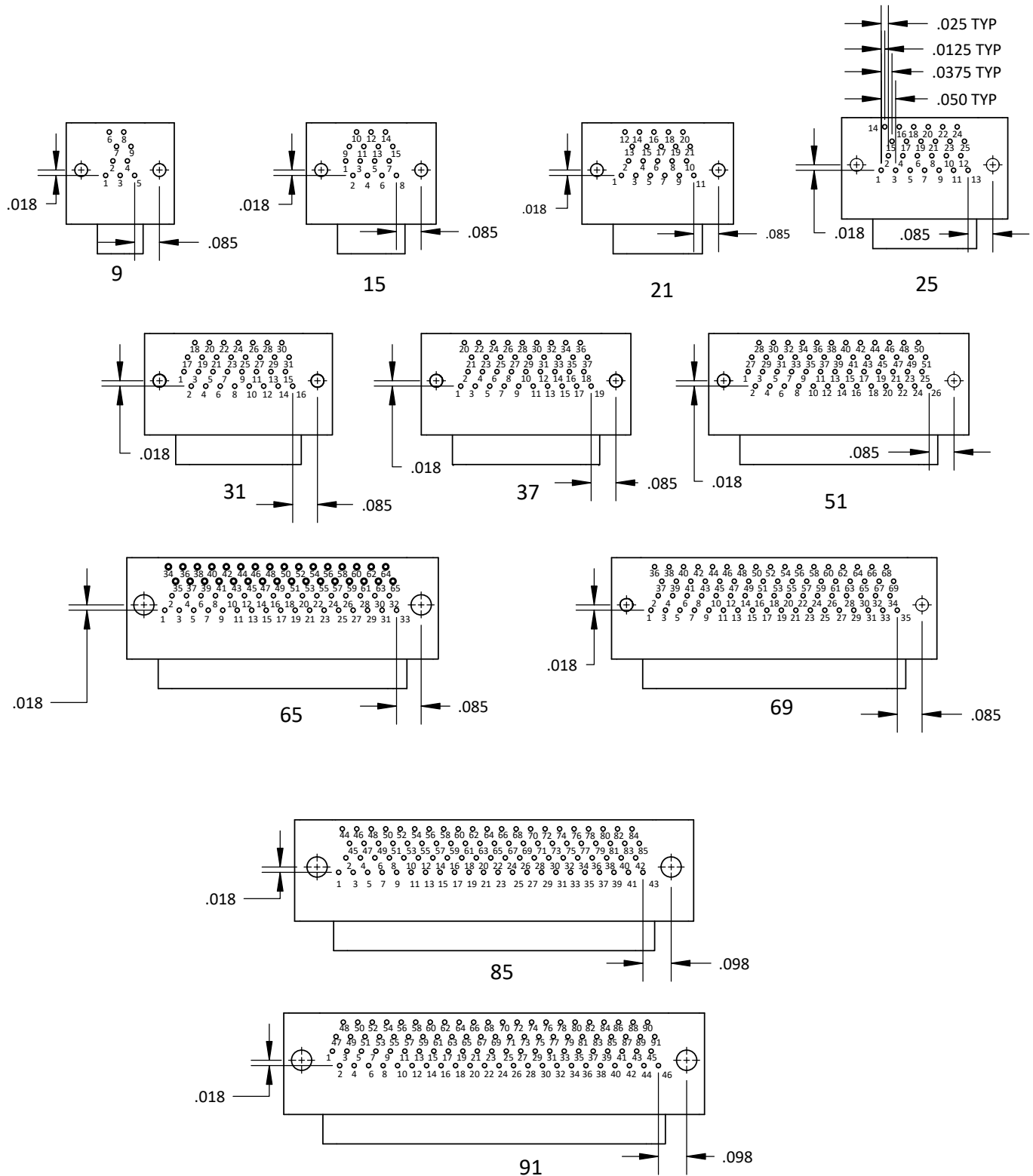

BRN2 RECEPTACLE PCB LAYOUTS
.050 X .050 GRID PATTERN OFFSET .025 (EACH ROW)

<p>TOLERANCE: .XXX ±.005 .XX ±.01 ANGLE ±1°</p>	<p>TITLE NANO METAL SHELL DUAL ROW RIGHT ANGLE BOARD MOUNT</p>	<p>SHT 4 OF 4</p>	<p>DWG. NO. BRN2</p>	<p>REV J</p>
---	---	-------------------	---------------------------------	-------------------------